

# ARV002

Angle valve 1/2"x3/8", square

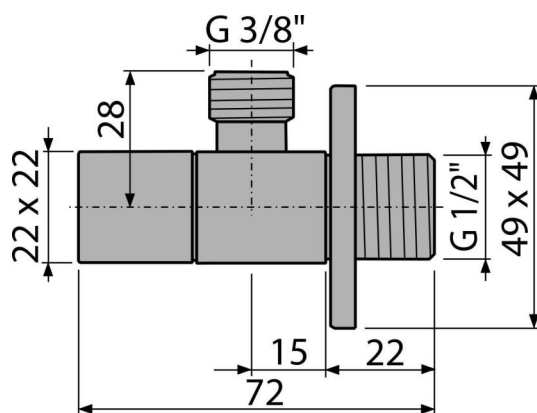

### Application

For installation on plaster  
For the connection of deck mounted faucet

### Features

- Design compatible with wash-basin trap A401
- Square design
- Material: chrome-plated metal

### Scope of supply

- Metal rosette
- Valve

### Order number, Logistic information

Code	EAN	Weight (piece   packing   palett)	Dimensions (piece   packing)	Quantity (packing   palett)
ARV002	8594045930894	0,17   12,24   362,7 kg	80x40x60   390x240x300 mm	72   2016 pcs

### Warranty

2/3 years \*

### Technical specifications

- Hose connector G 3/8 "
- Thread G 1/2 "