

# A46-50

Shower waste and trap with stainless steel grid

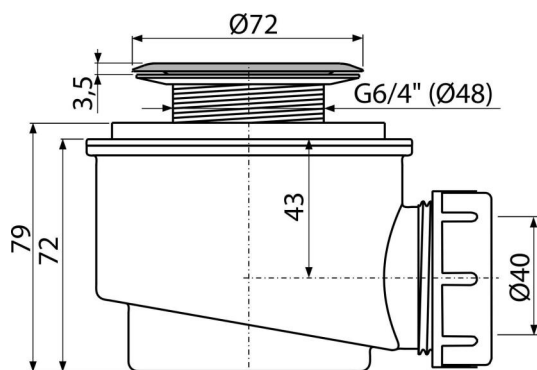

### Application

To drain the water from the shower trays  
 For shower trays without overflow  
 For shower trays with a drain outlet Ø50 mm

### Features

- Material: polypropylene, thermally and chemically resistant, longitudinally welded
- Waste can be connected using elbow A52
- Self-cleaning design of trap
- Building height 79 mm

### Scope of supply

- Assembly kit
- Stainless steel outlet grid
- Waste and trap body

### Order number, Logistic information

| Code   | EAN           | Weight<br>(piece   packing   palett) | Dimensions<br>(piece   packing) | Quantity<br>(packing   palett) |
|--------|---------------|--------------------------------------|---------------------------------|--------------------------------|
| A46-50 | 8594045933376 | 50 mm<br>0,21   6,31   196,7 kg      | 140×100×140   590×240×390 mm    | 30   840 pcs                   |

**Warranty**  
 2/3 years \*

**Norms**  
 EN 274

### Technical specifications

- Flow rate 49 l/min
- Thermal resistance 95 °C
- Odour trap 50 mm