

# A49ANTIC

Shower waste and trap, bronze-antic

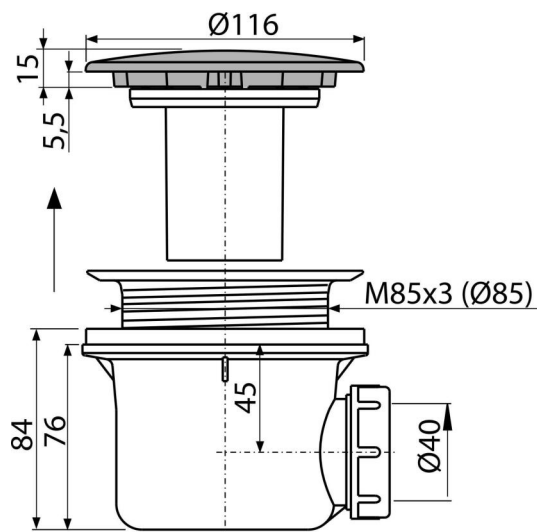

## Application

To drain the water from the shower trays  
For shower trays without overflow  
For shower trays with a drain outlet Ø90 mm

## Features

- Material: polypropylene, thermally and chemically resistant, longitudinally welded
- Waste can be connected using elbow A52
- Fully cleanable up to the waste pipe
- Building height 84 mm

## Scope of supply

- Metal waste and trap cover with bronze-antic finish
- Assembly kit
- Waste and trap body

## Order number, Logistic information

Code	EAN	Weight (piece   packing   palett)	Dimensions (piece   packing)	Quantity (packing   palett)
A49ANTIC	8595580528430	0,52   12,36   366,1 kg	150x110x140   590x240x390 mm	24   672 pcs

**Warranty**  
2/3 years \*

**Norms**  
EN 274

## Technical specifications

- Flow rate 43 l/min
- Thermal resistance 95 °C
- Odour trap 50 mm