

A106/1120

Mounting frame for handle

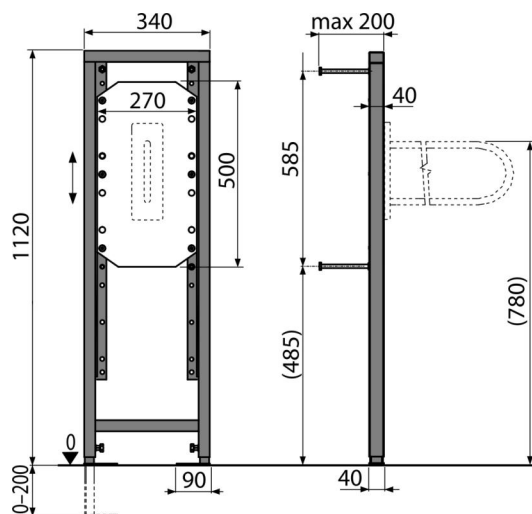

Application

Handle for the disabled

For mounting in front of a support wall or in to a plasterboard construction

Features

- Material: powder-coated metal
- Adjustable telescopic feet, range 0-200 mm
- Mounting plate for handle made from waterproof glued plywood

Scope of supply

- Fixation set: screw Ø8x60 – 4 pcs, dowel Ø12 – 4 pcs
- Self-supporting frame
- Mounting board for installation of handles for the disabled

Order number, Logistic information

Code	EAN	Weight (piece packing palett)	Dimensions (piece packing)	Quantity (packing palett)
A106/1120	8595580552718	11,14 11,14 354,1 kg	1126x340x78 1126x340x78 mm	1 30 pcs

Warranty

2/15 years *

Customs code

73089098

Norms

EN ISO 10535, 732030

Technical specifications

- Load test 200 kg