

# AS107S/1120

Mounting frame for urinal and sensor

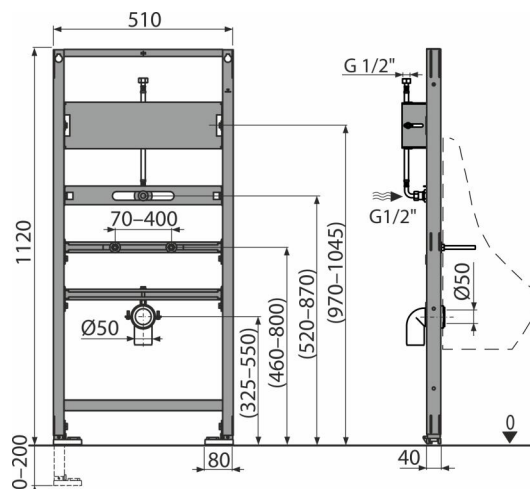

## Application

For automatic flushing system (sensor) before the bearing wall or into a plasterboard structure  
For mounting in front of a support wall or in to a plasterboard construction  
For wall-hung urinals

## Features

- Material: powder-coated metal
- Adjustable telescopic feet, range 0–200 mm
- Waste pipe adjustable 0–110 mm from center
- Water connection adjustable 0–125 mm from center
- Mounting pitch of the urinal is 80–280 mm
- Universal sensor holder – compatible with other types of sensors
- Height adjustable partitions

## Scope of supply

- Fixing hardware for mounting the urinal: M10 screw – 2 pcs
- Fixation set: screw Ø8×60 – 4 pcs, dowel Ø12 – 4 pcs
- Bracket for mounting the sensor
- Covers for the fixing material
- Waste elbow HT 50 with seal
- Self-supporting frame with a C-profile

## Order number, Logistic information

Code	EAN	Weight (piece   packing   palett)	Dimensions (piece   packing)	Quantity (packing   palett)
AS107S/1120	8595580577001	10,33   10,33   329,9 kg	1170×400×78   1170×400×78 mm	1   30 pcs

**Warranty** 2/15 years \* **Customs code** 73089098

## Technical specifications

- Load test 150 kg